

LOCATION PLAN

FOR PROPOSED G+4 STORIED BUILDING NAMED ROYAL CASTLE AT 23, S.C. DEB LANE , WARD NO- 07, UNDER KONNAGAR MUNICIPALITY, COMPRISED OF R.S. DAG NO.- 7696,R.S. KHATIAN NO.- 3653,L.R. DAG NO.- 11735,L.R. KHATIAN NO.- 13400 & 15562,P.S. - UTTARPARA,SUB DIVISION -SERAMPORE, DIST - HOOGHLY.(W.B.)

LATITUDE - 22.704064

LONGITUDE - 88.356771

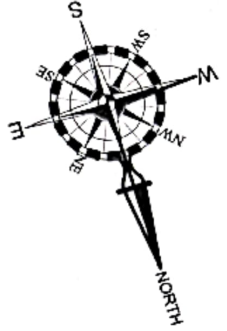

SCALE - 1:200

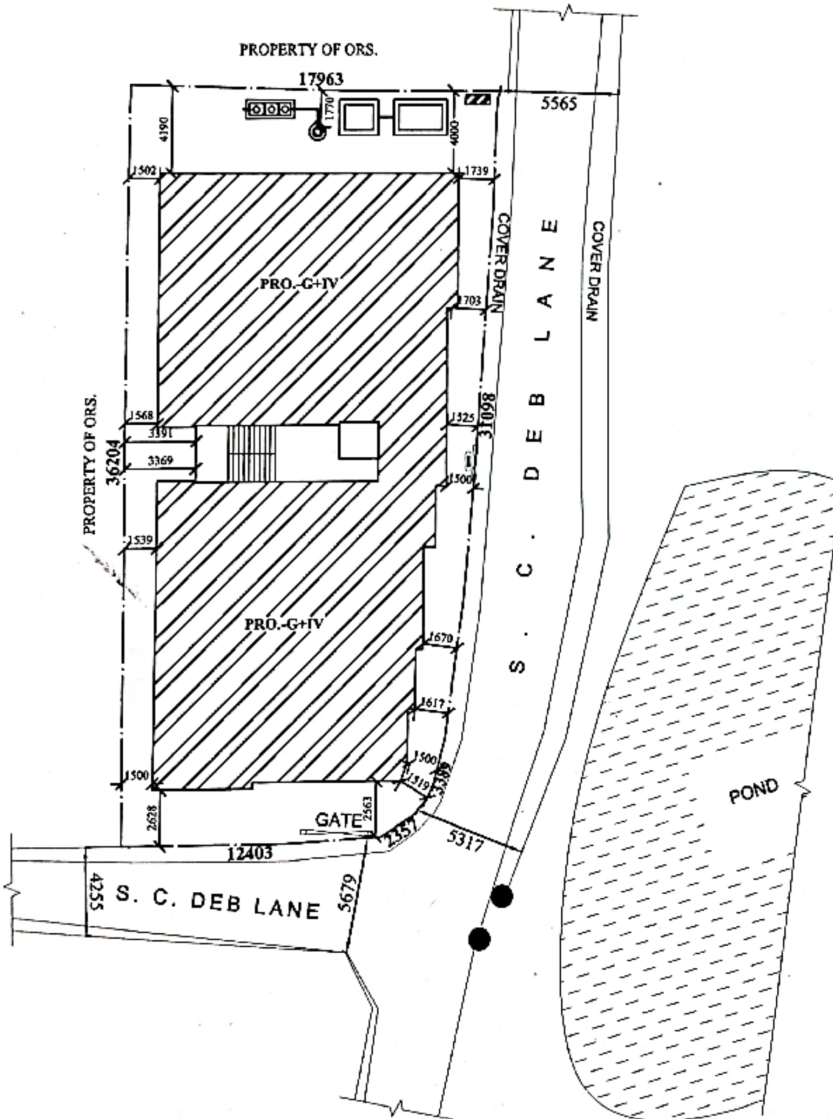

FOR RAHAMAN CONSTRUCTION

Rahaman Construction
Azade Rahman
Partner

KUNJAN MITRA
Empanelled Under Konnagar Municipality
Emp. No.- L.B.S. II/A/006/KM/PWD 2024/25

SIGNATURE OF L.B.S.